



## STREP A RAPID TEST

Rapid Test for the detection of group A  $\beta$ -hemolytic  
*Streptococcus* in pharyngeal swab



### STREPTOCOCCUS A

Group A  $\beta$ -hemolytic streptococcus (also known as *Streptococcus pyogenes*) is a Gram-positive bacterium that constitutes the most frequent bacterial cause of acute pharyngitis - 30/40% in European children and 5-15% in adults.

In order to properly treat the disease using antibiotic therapy, it is important to use an accurate diagnostic method to quickly identify the pathological agent.

### WHO ARE THE INTENDED USERS

Healthcare professionals with patients who present the following symptoms: sore throat, pain when swallowing, red and swollen tonsils, fever, weakness, nausea and vomit (especially in children). It's important to pay higher attention to children (higher incidence between 3-15 yrs) and fragile people (e.g. elderly persons).

### TEST PRINCIPLE

STREP A RAPID TEST is a rapid lateral flow immunochromatographic assay for the qualitative detection of specific streptococcus A antigens in human throat swab, thanks to special gold conjugate antibodies embedded to a test strip.

### TECH SPECS

CUT-OFF	SENSITIVITY	SPECIFICITY	OVERALL ACCURACY
10 <sup>4</sup> CFU/mL	91,89%	99,00%	97,90%

Performance data obtained by clinical study with 238 samples tested comparing with another rapid immunochromatographic test used as reference method.

### CLINICAL EVIDENCES

- Banerjee S, Ford C. "Rapid Tests for the Diagnosis of Group A Streptococcal Infection: A Review of Diagnostic Test Accuracy, Clinical Utility, Safety, and Cost-Effectiveness". Ottawa (ON): Canadian Agency for Drugs and Technologies in Health; 2018 May. CADTH Rapid Response Reports.
- Centers for Disease Control and Prevention. Adult appropriate antibiotic use summary. <http://www.cdc.gov/getsmart/community/materials-references/print-materials/hcp/adult-approp-summary.pdf> 2016.
- Llor C., Bjerrum L., Munck A., Cots JM., Hernández S., Moragas A.; HAPPY AUDIT Investigators. "Access to point-of-care tests reduces the prescription of antibiotics among antibiotic-requesting subjects with respiratory tract infections." *Respir Care*. 2014 Dec.

### HOW TO USE IT

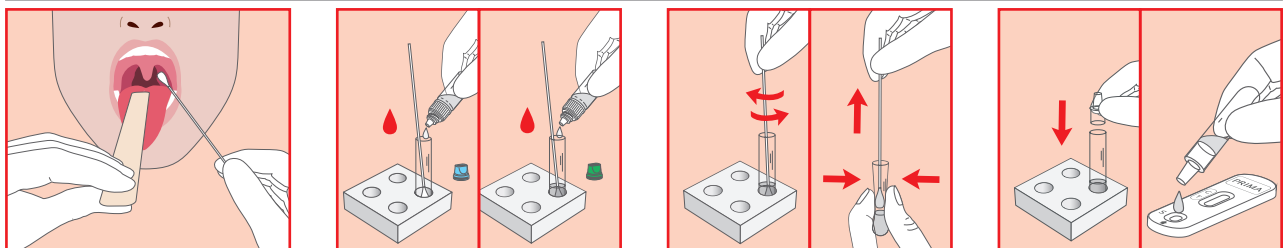

**CONTENT:** 20 test cassettes, 20 swabs, 20 tongue depressors, 20 empty test tubes with droppers, 1 R1 vial, 1 R2 vial, 1 workstation, 1 instruction for use.

REF	DESCRIPTION	NUMBER OF TESTS	SHELF LIFE
800060IP-20P	STREP A RAPID TEST	20 TESTS	30 MONTHS