



GIARDIA PET TEST

Rapid test for the qualitative identification of Giardia lamblia antigens in animal faeces



GIARDIA

Giardia lamblia is a microscopic protozoan contracted by oral ingestion. It attacks the inner wall of animal's small intestine and interferes with the normal fats and carbohydrates absorption during digestion.

WHO ARE THE INTENDED USERS

GIARDIA PET TEST is recommended to everyone who wants to check their pet's health status. More common symptoms are: nausea, diarrhea, fever and weight loss.

WHY - BENEFITS

It is important to diagnose Giardiasis as soon as possible. The disease, if not treated, can lead to chronic debilitation with anorexia, progressive culling, slimming and growth retardation.

TEST PRINCIPLE

Giardia Test is a lateral flow immunochromatographic assay which detects the Giardia antigen using highly specific monoclonal antibodies.

HOW TO USE IT

1) Collect the sample and dip the stick into feces in different points.

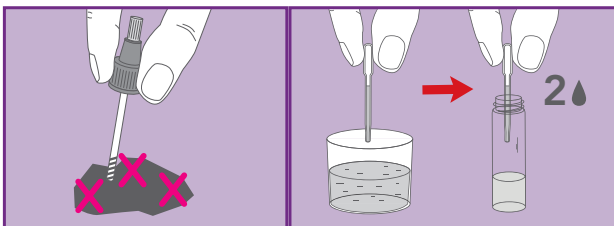

2) Put the stick in the stool extraction liquid and shake the vial.

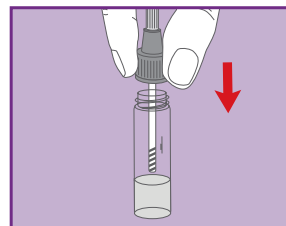

3) Apply 2 drops of the diluent stool sample. Wait 10 minutes and read the result.

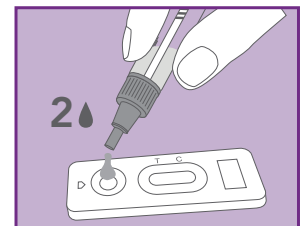

CONTENT: 1 sealed aluminum pouch containing: 1 GIARDIA PET TEST and 1 desiccant bag; 1 transparent plastic bag containing a pipette for specimen collection; 1 vial with green screw cap with collection stick and dripper; instructions for use.

REF	DESCRIPTION	NUMBER OF TESTS	SHELF LIFE
PET100-1	GIARDIA PET TEST	1 TEST	24 MONTHS